

Log_in



Log_in

Index

COUNTERS

STRUCTURAL FEATURES RECOMMENDED

CABLING SYSTEMS DISPLAYS

SERIES ADD-ONS

Iog_in

An elegant and functional series, the most functional of office tables. Its metal structure, ergonomic by nature, offers comfort and functionality to the user.

Elegance and design for tables that need to configure an organized, flexible and efficient workspace. A collection of work tables with a great technical development.

DECORATION AND STYLE IN THE WORK ENVIRONMENT

The incorporation of the wide range of Luxe finishes allows the office to be given an exclusive high-quality design.



TECHNICAL DESCRIPTION

OPENING IN THE SKIRT
FOR FOR WIRING

LUXURY COVERAGE / SYNCRON 18mm
ABOUT THE LUXE TABLE / SYNCRON 18mm
25 mm GOLD BILAMINATE

WINDOWS IN THE FOOT
WIRING



OPENINGS FOR WIRING

STRUCTURAL SKIRT LEVELERS

BILAMINATE

COUNTERS

THE LOGIN SERIES OFFERS A WIDE RANGE OF FINISHING OPTIONS:

LAMINATED COUNTERTOPS

Work surfaces made of wood particle board, available in n 25 mm thickness, glued with synthetic resins, medium density 630 kg/m³. Grupo Alvic complies with PEFC environmental protection regulations so that the wood used comes from sustainable farms. Melamine coating, with 2 mm thick PVC edge, applied with PUR (Hydroreactive Polyurethane Solid Adhesive) glue, innovation applied in the bonding process that offers a high performance of heat resistance and optimal behavior to humidity and solvents. The application of PUR glue in the gluing process is carried out using a gun that allows the glue to be applied only to the surface of the edge, without glue residues affecting the work surface, resulting in impeccable finishes on the table tops. The format of PUR glue, with its translucent colour, makes it practically invisible, and its composition is also more adherent than traditional glue. The result is high-quality finishes that are far superior to the traditional gluing system. The edges of the edges are rounded to R=2 mm, with the edges and corners of the work surface being rounded

SYNCRON MEDIUM-PRESSURE LAMINATE COUNTERTOPS (NATURAL RELIEF)

Particleboard with a thickness of 18 mm and an average density of 630 kg/m³. Its formaldehyde content is less than 8 mg/100g (class E1)

Medium-pressure laminate coating (natural relief)

SYNCRON synchronizes designs with relief, providing a natural finishing feel that is unique on the market.

Verso in the same flat finish

2 mm thick ABS edge, applied with PUR (Solid Adhesive Polyurethane Hydroreactive) glue.

LUXURY COUNTERTOPS

High-density fibreboard, medium density 720 kg/m³, with a thickness of 18.3 mm (tolerance +/-0.3 mm). Glossy and matte design, using a state-of-the-art lacquer process that provides a high degree of strength and (stable gloss over 100 gloss).

The edged panel with ABS edge and polyurethane glue application for glossy finishes, and the application of edge technology with laser technology for matt finishes. The back is available in a matt design finish.

For the table tops, there is a "glass" edge, which incorporates a translucent strip on its top and the countertop's own finish on the bottom.

SEE THE TECHNICAL SHEETS OF THE FINISHES

● METAL STRUCTURE

Side legs in 2 mm thick pickled steel tube, welded in one piece, with the column off-center towards the confidant. The resulting side has **windows at the top and bottom ends** to allow wiring through the column.

It features removable leg pads with height-adjustable polypropylene levelers with a non-slip sole at the base.

In the painting process of the structure, a pre-treatment is carried out that creates a nanometric inorganic conversion layer based on synthetic ceramic compounds. This process improves the adhesion of the paint, as well as the corrosion resistance of the assembly. Then apply oven-cured epoxy-polyester powder paint to **Smooth finish** in color **metallised aluminium (RAL 9006 comparison)** and **White** (comparison RAL 9003) with an average thickness of 80 to 100 microns. OFITRES contributes as a **NOVELTY** the New metallic aluminium finish, based on metal particles that give it a superior shine and surface quality, as well as an attractive and modern appearance.

Additional beam in 30x30 mm pickled steel with a thickness of 2 mm in the case of the Luxe or Synchron worktops, in order to avoid any deformation of the table top.

Inside of the foot

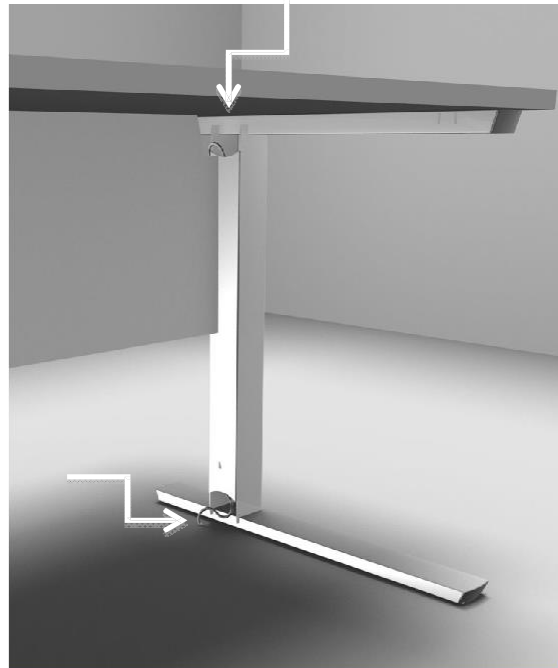

TAIL

Made of particleboard with a 19 mm thick melamine coating, in the same finish as the table surface. PVC edge 1.5 mm thick, applied with PUR (Solid Hydroreactive Polyurethane Adhesive) glue.

The melamine skirt is connected at the sides by M6 metal shafts and eccentrics, and fulfills a structural function.

The skirt has windows at both ends, in their fit with the pedestal that allow wiring to pass through the electrification tray, located inside.

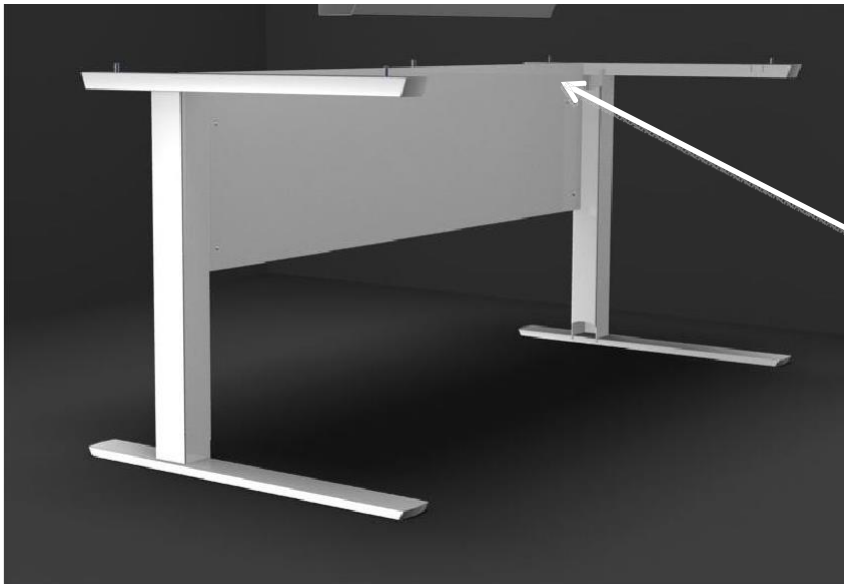

CABLE TRAY FOR SINGLE TABLE

There is a tray, a horizontal electrification channel for **INDIVIDUAL TABLE** that allows the installation of cables after assembly, with sufficient capacity to accommodate the connection, power, telephone and data boxes, facilitating the handling of the wiring.

They are screwed to the table top and are located behind the table skirt.

Photo cable tray

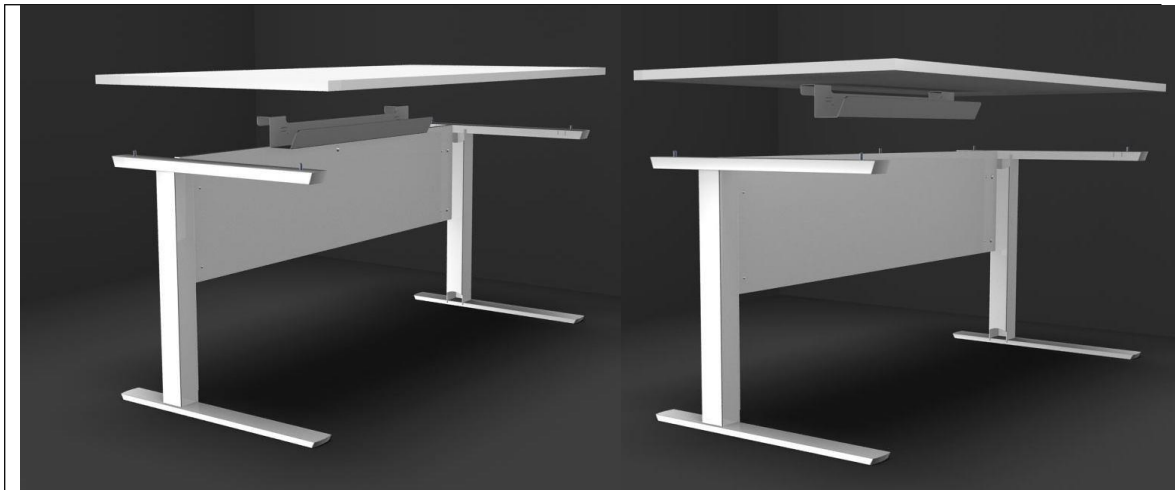
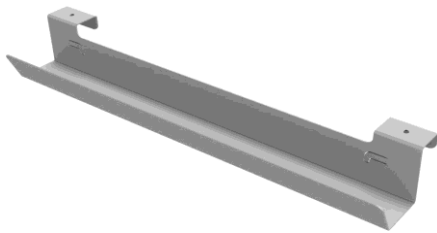

There are also universal trays (code 8.2517) dimensions L 105X D7.3 X H2.9. This tray fulfills the function of maintaining wiring, as it does not have the same capacity as the previous one



WIRING THE WORKTOP ACCESS

Through the hole that has the skirt on both sides, in its fit with the pedestal. Allows wiring to pass from the table surface to the electrification tray located inside the table.



There are recessed electrification elements, rectangular cable protectors.



These rectangular cable protectors measure 320 x 110 x 13, measurements that allow maximum accessibility to wiring and connections, as their width allows for all-hand access. They are available in aluminium and white finishes.

This cable protector allows for perfect optimization of the work surface. It is a useful solution for single and double tables.





- 8-diameter cable grommet

A wide variety of power strips and electrification solutions are also available.
SEE ELECTRIFICATION DATA SHEETS.

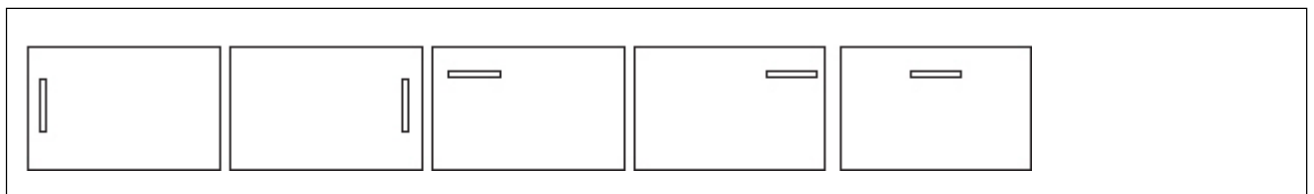
The following positions are available for the eyelet



<p>SCREENS</p>	<p>Available finishes for the SCREENS:</p> <ul style="list-style-type: none"> ● BILAMINATE ● IRIS: Glossy laminate on both sides in white, black, pistachio and aubergine.
	

Universal processor support

Made of sheet steel, it is a functional and practical element for the CPU location. It is screwed to the table top.

Grupo Alvic FR Mobiliario, S.L. Tavèrnoles 5, Pol. Ind. Malloles 08500 Vic – Barcelona – Spain
T. (34) 93 889 25 02 F.(34) 93 889 11 57 www.ofitres.com ofitres.ofi@grupoalvic.com